

## Dimensions

unit: Inch (mm)

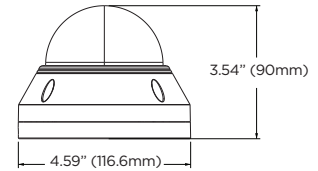

## Summary

These MEGApix® IP cameras are NDAA compliant and deliver crystal-clear images at 4MP resolution and real-time 30fps. The vandal dome camera features a 2.8mm fixed lens in an IP67-rated, IK10 impact-resistant housing. Added intelligence includes line crossing, perimeter intrusion and video tampering detection. All MEGApix cameras are ONVIF conformant, assuring their successful integration with any open platform solution on the market.

## Features

- 4MP 1/3" image sensor at real-time 30fps
- 2.8mm fixed lens
- True Wide Dynamic Range (WDR) for clear images in challenging light
- Simultaneous streaming and multiple codec options for smart bandwidth management
- 100' Smart IR™ with intelligent camera sync for clear B/W images with no need for external light
- Line crossing video analytics
- Perimeter intrusion video analytics
- Video tampering with scene-change, video-blur and abnormal color detection video analytics.
- Smart DNR™ 3D digital noise reduction reduces noise and ghosting for motion in low-light environments.
- Privacy zones cover sensitive areas in the camera's field of view.
- Backlight compensation (BLC)
- Built-in microphone and audio input for direct communication between the monitoring station and the camera's location
- Local SD card slot for local recording in case of network loss
- Web server built-in for easy camera management from any browser
- PoE and DC12V for single cable simplified installation
- NDAA compliant for federal and government projects
- IP67- and IK10-rated camera housing built to last
- 5 year warranty



## Mounting accessories (Optional)



## Specifications



<b>IMAGE</b>	
Image sensor	4MP 1/3" CMOS
Total pixels	2560 x 1440
Minimum scene illumination	0.005 lux (color) 0.0 lux (B/W)
S/N ratio	50dB
<b>LENS</b>	
Focal length	2.8mm, F1.6
Lens type	Fixed lens
Horizontal Field of View	94°
Vertical Field of View	50°
IR distance	100ft range
<b>I/O</b>	
Audio in / out	1 audio input and 1 microphone built-in
Audio compression	G.711A / U
<b>OPERATIONAL</b>	
Shutter mode	Auto, manual
Shutter speed	1/2s - 1/100000s
Auto gain control	Auto
Day / night	Auto, day (color), night (B/W), schedule
3D DNR	Smart DNR™ 3D digital noise reduction
Wide dynamic range (WDR)	True WDR, 120dB
Privacy zone	8 programmable privacy masks
Video analytics	Line crossing, perimeter intrusion, video tampering detection (scene change, video blur, abnormal color)
Backlight compensation (BLC)	Yes
Mirror and flip	Yes
Alarm notifications	Notifications via email or FTP server
Memory slot	Micro SD, SDHC, SDXC up to 256GB (card not included)
<b>NETWORK</b>	
LAN	802.3 compliance 10/100 LAN
Video compression type	H.265, H.264, MJPEG
Resolution	4MP, 3MP, 2.1MP/1080P, 720P, D1, 480x240, CIF (60Hz: 1 - 30fps; 50Hz: 1-25fps)
Frame rate	Up to 30fps at all resolutions
Video bitrate	64 Kbps - 8 Mbps
Bitrate control	Multi-streaming CBR/VBR at H.264/ H.265 (controllable frame rate and bandwidth)
Streaming capability	Dual-stream at different rates and resolutions Maximum three (3) connections/streams at a time
IP	IPv4, IPv6
Protocol	UDP, IPv4, IPv6, DHCP, NTP, RTSP, RTP, RTCP, ICMP, IGMP, PPPoE, DDNS, SMTP, FTP, SNMP, HTTP, 802.1x, UPnP, HHTPs, QoS
Security	IP filtering, MAC filtering, authentication (ID/PW), SSL/TSL
ONVIF conformance	Yes
Web viewer	OS: Windows®, Mac® OS, Linux® Browser: MS Edge, IE, Chrome, Firefox DW Spectrum® IPVMS
Video management software	DW Spectrum® IPVMS
<b>ENVIRONMENTAL</b>	
Operating temperature	-22°F - 140°F (-30°C - 60°C)
Operating humidity	0-95% RH (non-condensing)
IP rating	IP67-rated
IK rating	IK10 impact-resistant
Other certifications	FCC, CE, ROHS, ONVIF, NDAA
<b>ELECTRICAL</b>	
Power requirement	DC 12V, PoE (Adapter not included)
Power consumption	<4.5W
<b>MECHANICAL</b>	
Material	Metal vandal housing, polycarbonate dome
Dimensions	4.59" x 3.54" (116.6x 90 mm)
Weight	1.43 lb (0.65 kg)
Warranty	5 year warranty



866.446.3595

sales@digital-watchdog.com

www.digital-watchdog.com

Built for Users.™

